

MACOMB COUNTY REMONUMENTATION PROGRESS MAP

T5N R12E
BRUCE TOWNSHIP &
VILLAGE OF ROMEO

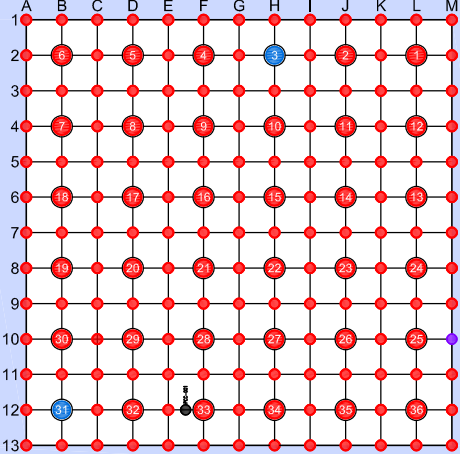

T5N R13E
ARMADA TOWNSHIP &
VILLAGE OF ARMADA

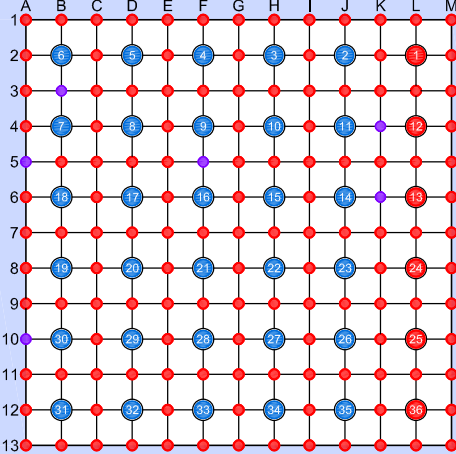

T5N R14E
RICHMOND TOWNSHIP, CITY OF
RICHMOND & CITY OF MEMPHIS

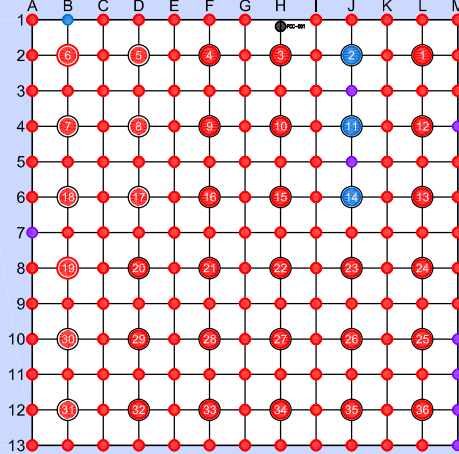

T4N R12E
WASHINGTON TOWNSHIP &
VILLAGE OF ROMEO

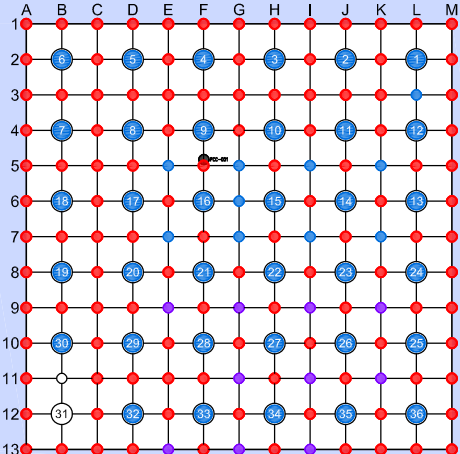

T4N R13E
RAY TOWNSHIP

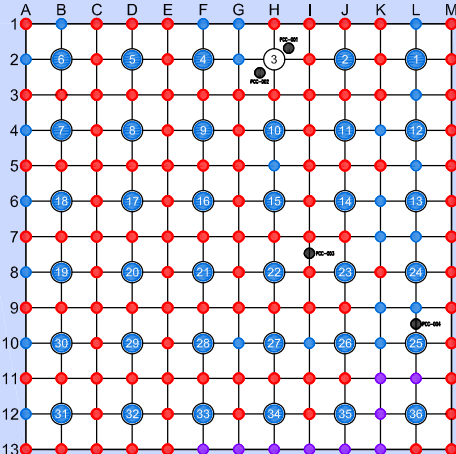

T4N R14E
LENOX TOWNSHIP, CITY OF
RICHMOND & VILLAGE OF NEW HAVEN

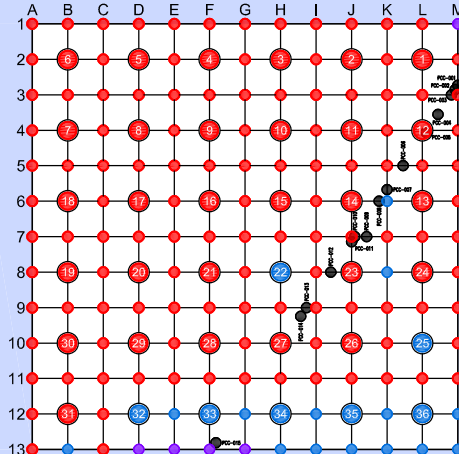

T3N R12E
SHELBY TOWNSHIP &
CITY OF UTICA

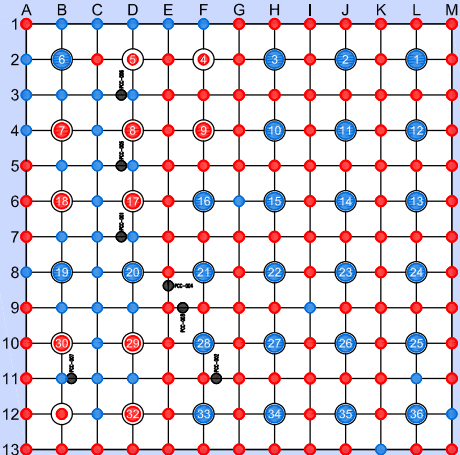

T3N R13E
MACOMB TOWNSHIP

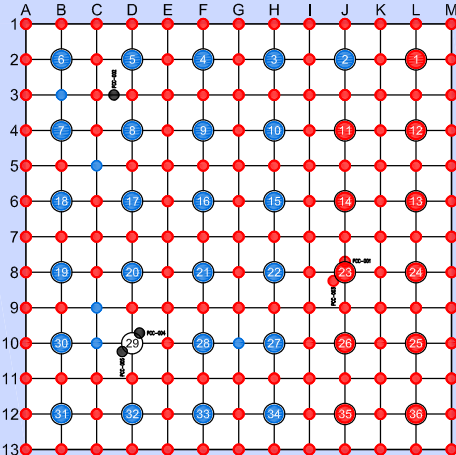

T3N R14E & PART OF T3N R15E
CHESTERFIELD TOWNSHIP &
CITY OF NEW BALTIMORE

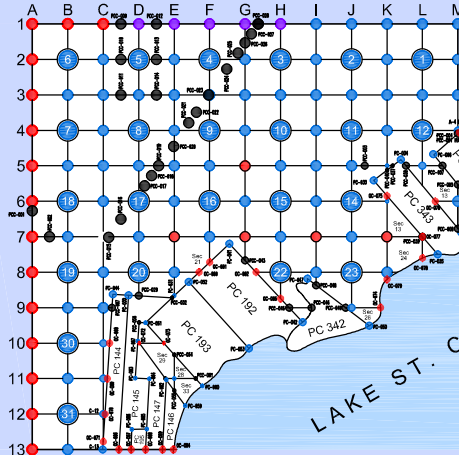

T2N R12E
CITY OF STERLING HEIGHTS &
CITY OF UTICA

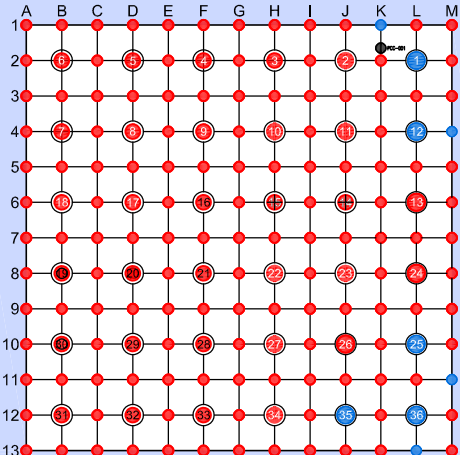

T2N R13E
CLINTON & HARRISON TOWNSHIP,
CITY OF MOUNT CLEMENS

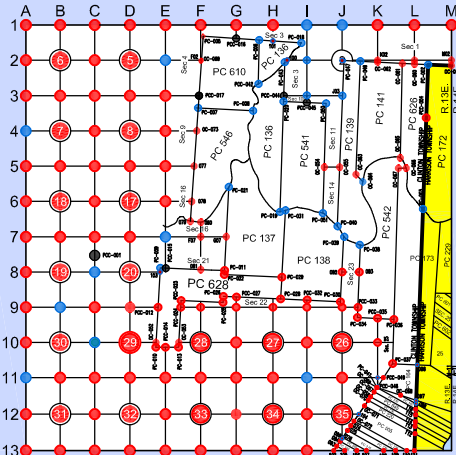

T2N R14E & PART OF R13E
HARRISON TOWNSHIP &
CITY OF MOUNT CLEMENS

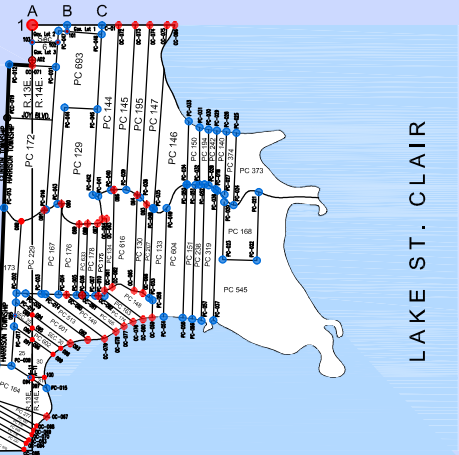

T1N R12E
CITY OF WARREN, CITY OF CENTER
LINE & CITY OF EASTPOINTE

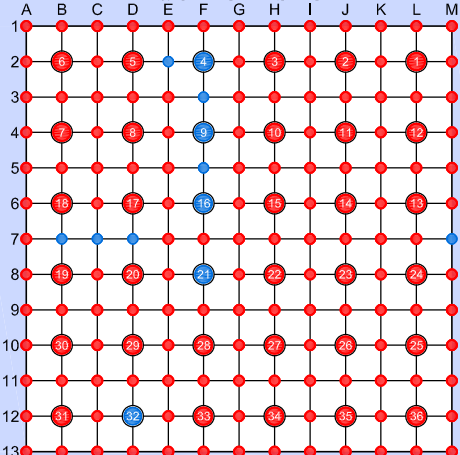

T1N R13E
ERIN/LAKE TOWNSHIP, CITY OF FRASER,
ROSEVILLE, EASTPOINTE & ST. CLAIR SHORES

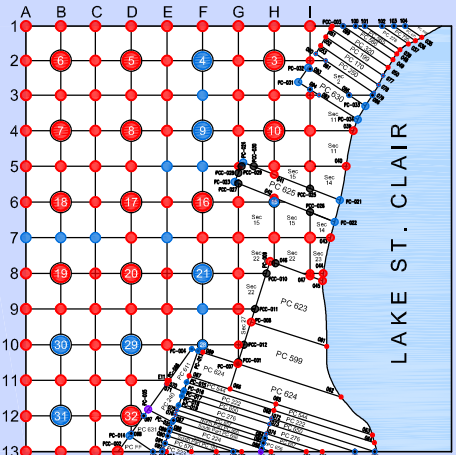

Anthony G. Forlini

Macomb County Clerk -
Register of Deeds

Brian Brdak

Remonumentation Grant Administrator

Catherine M. DeDecker, P.S.

Remonumentation
Surveyor Representative



2023 CONTRACT SURVEYORS

Giffels Webster
Kennedy Surveying Inc.
Seiber, Keast, Lehner Inc.
Michigan Surveying Inc.
Spalding DeDecker Associates, Inc.

LEGEND

- CORNERS REMONUMENTED
- PROPERTY CONTROLLING CORNERS REMONUMENTED
- REMONUMENTATION CORNERS WITH STATE PLANE COORDINATE ASSIGNED
- PROPOSED STATE PLANE CORNER 2023
- PROPOSED CORNER WITH STATE PLANE COORDINATE 2023

Note: Map Not To Scale